



PELTOR™

3M™ PELTOR™ ComTac VI Quick Guide



3M Personal Safety Division

3M Svenska AB

Dannie Karlsson | Application Engineer

Ingelundsvägen 21

S-33140 Värnamo

Sweden

Email: dkarlsson@mmm.com

Telephone: +46 (0) 370 - 65 64 98

Quick guide

Replacing the batteries

Fig 1

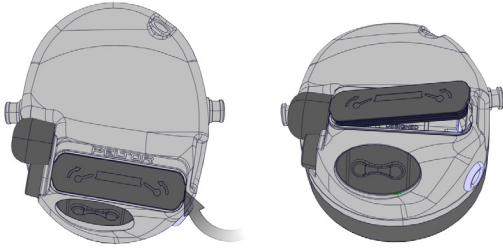

Remove the battery lid..

Fig 2

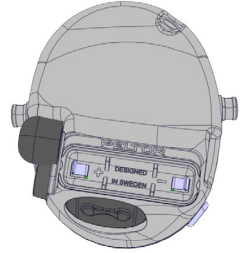

Insert or replace battery. Make sure the polarity corresponds to the markings.

Fig 3



Close the lid.

Power On/Power Off

Fig 4

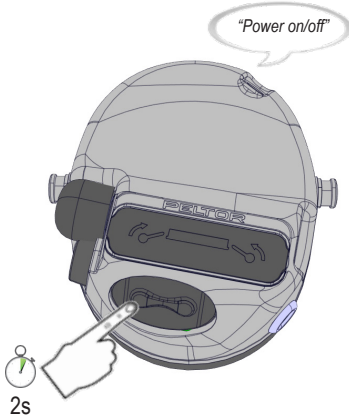

Press and hold the + or - button for two seconds to power on or off the headset. The voice guide will confirm with "Power on" or "Power off".

Surround volume

Fig 5

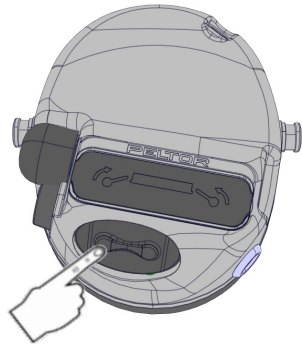

Press the + or - button to adjust the surround sound. The lowest and highest sound setting are confirmed by a "beep" sound.

Menu Fig 6

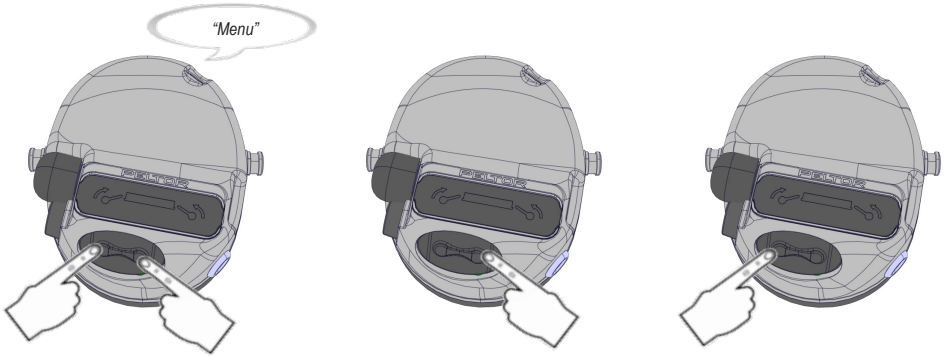

Press and hold the + and – button simultaneously to enter the menu. The voice guide will confirm with "Menu".

Press the – button to navigate through the different steps, the voice guide will confirm each menu step.

Press the + button to adjust, activate or deactivate the functions.

Plug mode Fig 7

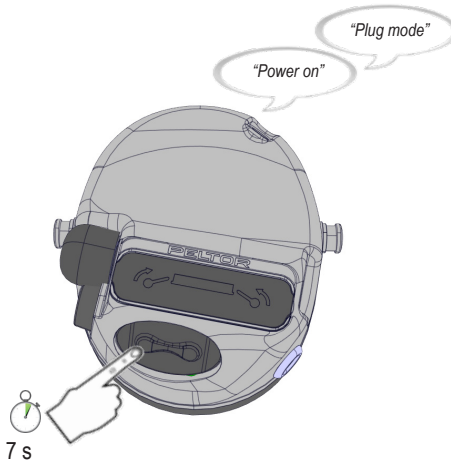

Press and hold the + or – button for two seconds to power on the headset. The voice guide will confirm with "Power on". Keep pressing the button until the voice confirm with "Plug mode".

PTT for face-to-face communication

Fig 8

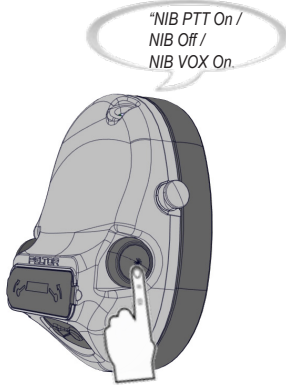

Double press the PTT button to toggle between the different modes, NIB PTT On - NIB Off - NIB Vox On.

Fig 9

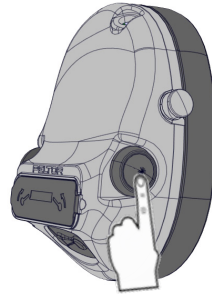

Press and hold the PTT button to transmit.

Menu Tree

Fig 10

